

APPROVED: \_\_\_\_\_  
 DATE: \_\_\_\_\_ TITLE: \_\_\_\_\_

| Rev | AWO # | Description    | Date    | Appr  |
|-----|-------|----------------|---------|-------|
| -   |       | RELEASED       | 3/20/17 |       |
| A   |       | UPDATE DRAWING | 3/19/20 | LH/AC |

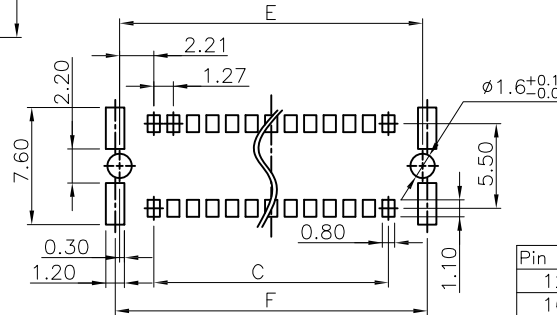
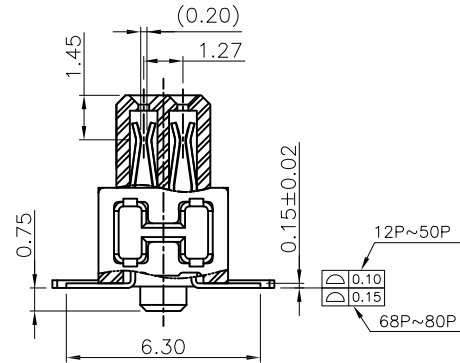
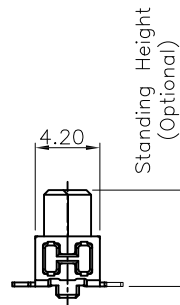
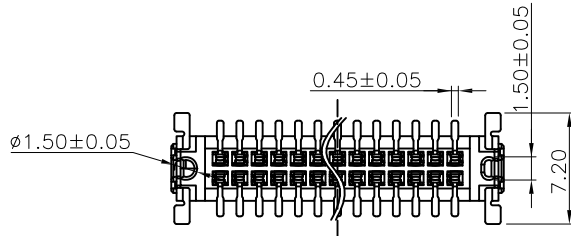
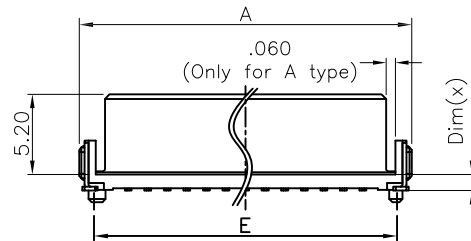
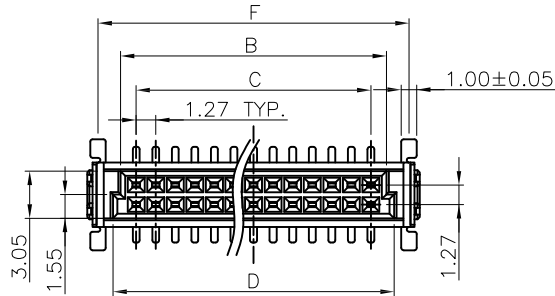

RECOMMENDED PCB LAYOUT

| Pin No. | A     | B     | C     | D     | E     | F     |
|---------|-------|-------|-------|-------|-------|-------|
| 12      | 12.70 | 8.37  | 6.35  | 9.37  | 10.77 | 11.34 |
| 16      | 15.24 | 10.91 | 8.89  | 11.91 | 13.31 | 13.88 |
| 20      | 17.78 | 13.45 | 11.43 | 14.45 | 15.85 | 16.42 |
| 24      | 20.32 | 15.99 | 13.97 | 16.99 | 18.39 | 18.96 |
| 26      | 21.59 | 17.26 | 15.24 | 18.26 | 19.66 | 20.23 |
| 30      | 24.13 | 19.80 | 17.78 | 20.80 | 22.20 | 22.77 |
| 32      | 25.40 | 21.07 | 19.05 | 22.07 | 23.47 | 24.04 |
| 40      | 30.48 | 26.15 | 24.13 | 27.15 | 28.55 | 29.12 |
| 50      | 36.83 | 32.50 | 30.48 | 33.50 | 34.90 | 35.47 |
| 68      | 48.26 | 43.93 | 41.91 | 44.93 | 46.33 | 46.90 |
| 80      | 55.88 | 51.55 | 49.53 | 52.55 | 53.95 | 54.52 |

**SPECIFICATIONS:**

Material:  
 Insulator: Hi-temp thermoplastic, rated UL 94V-0  
 Insulator color: Black  
 Contacts: Phosphor Bronze  
 Board Lock: Brass, Tin plated  
 Plating:  
 Gold flash over Nickel underplate on contact area,  
 Tin over Nickel underplate on solder tails  
 Electrical:  
 Current rating: 1.2 Amp max  
 Contact resistance: 25 mohms max  
 Insulation resistance: 1000 Mohms min  
 Withstanding voltage: 500 VAC for 1 minute  
 Temperature Rating:  
 Operating temperature: -55°C to +125°C  
 Environmental:  
 Lead free, RoHS compliant.



PACKAGED ON TAPE & REEL

|   |       |         |  |
|---|-------|---------|--|
| UNLESS OTHERWISE SPECIFIED<br>ALL DIMENSIONS ARE MILLIMETERS<br>TOLERANCES: EXCEPT AS NOTED |       |         |  |
| MM  | ANGLE |         |  |
| .X ± 0.35   | ± 2°  |         |  |
| .XX ± 0.20  |       |         |  |
| .XXX ± 0.10   |       |         |  |
| APPROVALS   |       | DATE    |  |
| DRAWN   | AY    | 3/20/17 |  |
| CHECKED   | MC    | 3/20/17 |  |
| APPROVED  |       |         |  |

**ADAM TECH** INTERCONNECTS  
 909 Rahway Avenue,  
 Union, NJ 07083  
 Phone: 908-687-5000  
 Fax: 908-687-5710

|  |  |              |  |
|--|--|--------------|--|
| TITLE<br>1.27mm BOARD TO BOARD STACKING<br>CONNECTOR, FEMALE, VERTICAL, SMT TYPE |  |              |  |
| SIZE<br>X  | PART NO.<br>ESMC-F-XX-SGS-SMT-X-PP-T/R | REV.<br>A    |  |
| REF: S00242T   | SCALE: NTS                             | SHEET 1 OF 2 |  |

6

5

4

3

2

1

APPROVED: \_\_\_\_\_

DATE: \_\_\_\_\_ TITLE: \_\_\_\_\_

Rev | AWO # | Description | Date | Appr

SEE SHT 1 OF 2 FOR REVISION

Male Series

Matting →

Female Series

| Part No.                   | Connector Height |         | Stacking Height |
|----------------------------|------------------|---------|-----------------|
|                            | (Y)Female        | (X)Male | H(Matting)      |
| ESMC-F-XX-SGS-SMT-A-PP-T/R | 6.25             | 6.75    | 8.0             |
|                            |                  | 8.25    | 9.5             |
|                            |                  | 9.85    | 11.1            |
| ESMC-F-XX-SGS-SMT-B-PP-T/R | 9.05             | 6.75    | 10.8            |
|                            |                  | 8.25    | 12.3            |
|                            |                  | 9.85    | 13.9            |
| ESMC-F-XX-SGS-SMT-C-PP-T/R | 13.65            | 6.75    | 15.4            |
|                            |                  | 8.25    | 16.9            |
|                            |                  | 9.85    | 18.5            |

UNLESS OTHERWISE SPECIFIED  
ALL DIMENSIONS ARE MILLIMETERS  
TOLERANCES: EXCEPT AS NOTED

|             |       |
|-------------|-------|
| MM          | ANGLE |
| .X ± 0.35   | ± 2°  |
| .XX ± 0.20  |       |
| .XXX ± 0.10 |       |

**ADAM TECH** INTERCONNECTS  
909 Rahway Avenue,  
Union, NJ 07083  
Phone: 908-687-5000  
Fax: 908-687-5710

APPROVALS | DATE

DRAWN: AY | 3/20/17

CHECKED: MC | 3/20/17

APPROVED: \_\_\_\_\_

TITLE: 1.27mm BOARD TO BOARD STACKING CONNECTOR, FEMALE, VERTICAL, SMT TYPE

SIZE: X | PART NO.: ESMC-F-XX-SGS-SMT-X-PP-T/R | REV.: A

REF: S00242T | SCALE: NTS | SHEET 2 OF 2

6

5

4

3

2

1